

PL-52A12G

2MP 12x Starlight Network PTZ



- 1/2" Starlight 2MP Sony Sensor
- Max 25/30fps@2MP Recording
- Support Dual Stream Encoding
- IP66 Rating
- DWDR/BLC/2D&3D Noise Reduction



System Overview

PL-52A series super low light dome is a range of competitive 6 inch PTZ with compact design. The series are ideal choices for SMB solutions, such as buildings, factories, schools which are designed for indoor and outdoor.

With pan speed up to 480°/s, and tilt speed up to 240°/s, promise a large viden coverage and secured details. Its rugged casing is rated with IP66.

Functions

H.265+

Delivering high quality video with up to 70% lower bandwidth.

H.265+ is the optimized evolution of H.265 and traditional H.264.

The Smart H.265+ includes a series of encoding strategy like Dyamic ROI, smart 2D&3D noise reduction etc to save up to 70% bandwidth and storage.

Harsh conditions

ZKTeco PTZ cameras could run normally in harsh environment, working temperature range from -40℃ ~+60℃ with 95% humidity.

Technical Parameters

Camera

| | | | |
|--------------|--------------------------------|--------------------|------------------|
| Model | PL-52A12G | Scanning System | Progressive |
| Image Sensor | Starlight 2MP 1/2" Sony Sensor | Electronic Shutter | 1/2s - 1/20,000s |
| Lens | 12X f=7mm~84mm | | |

Video

| | | | |
|-------------------|---|------------------|----------------------------|
| Video Compression | H.265+/H.265/H.264+/H.264 | WDR | DWDR |
| Resolution | 1080P(1920x1080)/720P(1280x720) /CIF(352X288/352X240) | Day/Night | Auto(ICR)/Color/B/W |
| Bit Rate Control | CBR/VBR | White Balance | Auto/Manual/Indoor/Outdoor |
| Bit Rate | Main stream: 64Kbps~1000Kbps Sub stream: 32Kbps~2000Kbps | Gain Control | Auto |
| Audio Compression | G.711a/G.711u(32Kbps)/PCM(128Kbps) | Noise Reduction | 2D & 3D DNR |
| BLC | Supported | Motion Detection | Supported |
| | | Privacy Mask | Up to 4 areas |

Optional

| | | | |
|-----------|----------|--------------|----------|
| Audio I/O | Optional | SD card slot | Optional |
| Alarm I/O | Optional | | |

Network

| | | | |
|----------|---|------------------|--------------------------------|
| Protocol | RTSP,FTP,SMTP,TCP/IP,UDP,DHCP,RTSP,ARP,DNS,DDNS | Max. online User | Main stream : 3 Sub stream : 6 |
| Onvif | Onvif profile S | Web Browser | IE,Chrome,Firefox |

P/T

| | | | |
|----------------|--|----------------------|------------------|
| Pan/Tilt Range | Pan: 0°~360°, Tilt: 0°~93° | Ingress Protection | IP66 |
| Pan Speed | 0~480°/s | Working Environment | -40℃~+60℃ |
| Tilt Speed | 0~240°/s | Power Supply | DC 12V4A |
| Preset | 220 | Lightning Protection | EDS 6000V |
| Preset Speed | 1-64 optional | OSD Menu | Call 95 Preset |
| PTZ Mode | 8 tour, 4 pattern, 1 horizontal scan | Default Bracket | Wall Mount |
| Idle Motion | Activate preset/Scan/ Tour if there is no command in specified period | Dimensions | Φ210(mm)×287(mm) |
| Protocol | Pelco-D, Pelco-P | Net Weight | 2.5KG |
| | | Gross Weight | 4.5KG |

Ordering Information

| Type | Part Number | Description |
|----------------|-------------|---------------------------------------|
| 2MP PTZ Camera | PL-52A12G | 5MP PTZ camera |
| | PL-52A12G-M | 5MP PTZ camera with alarm and SD slot |
| | PL-52A12G-A | 5MP PTZ camera with audio and SD slot |
| Accessories | MT01 | Corner mount |
| | MT02 | Pole mount |
| | PB02 | Pendant Mount |

Dimensions (mm)

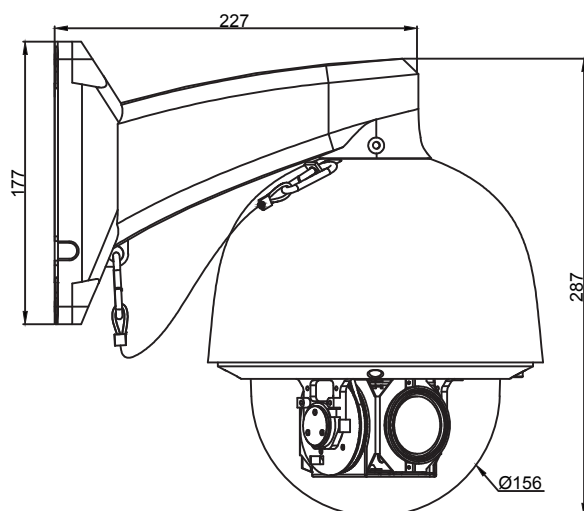

Accessories

Included:



Wall Mount



DC12V/4A
Power Supply

Optional:



PB02
Pendant Mount



MT02
Pole Mount



MT01
Corner Mount

| Wall Mount | Pendant Mount |
|--------------|---------------|
| Default | PB02 |
| | |
| Corner Mount | Pole Mount |
| MT01 | MT02 |
| | |



More details

ZKTECO CO.,LTD.
www.zkteco.com
E-mail: sales@zkteco.com

Copyright ©2018 ZKTECO CO., LTD. All rights reserved.

